

Storage Instructions

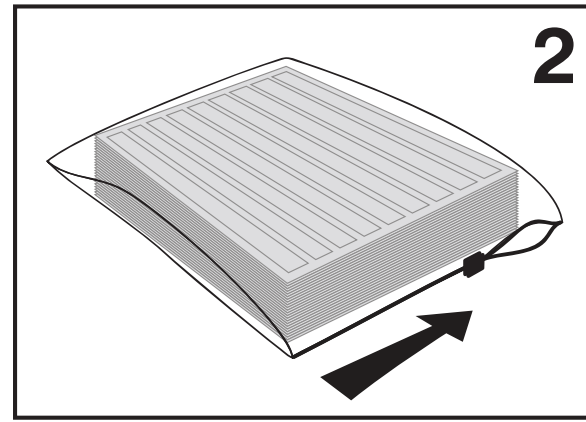

We have enclosed a plastic bag for your convenience to store your wristbands in. This is to keep them in the best condition for laser printing.

Usage Instructions

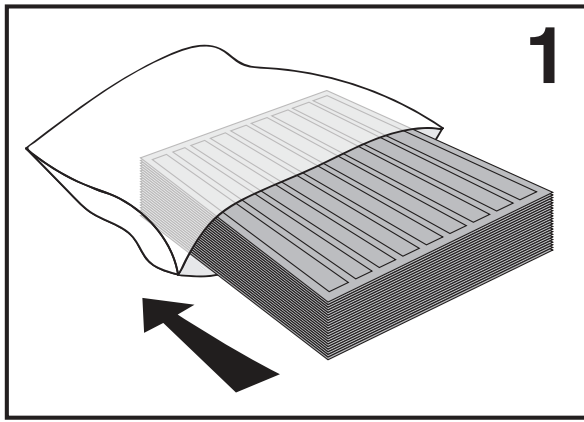
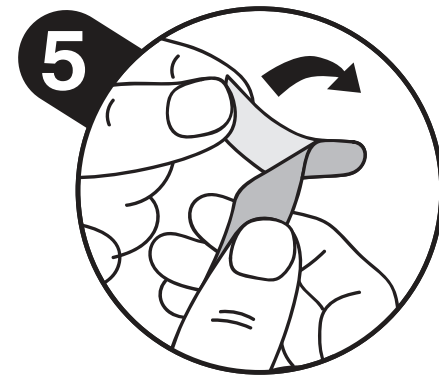
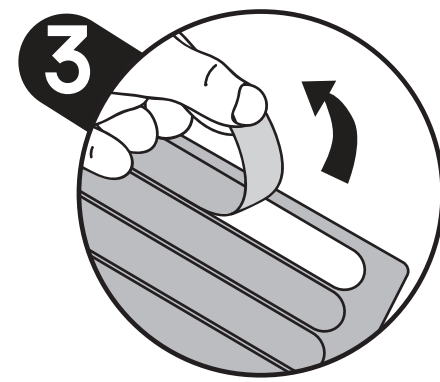
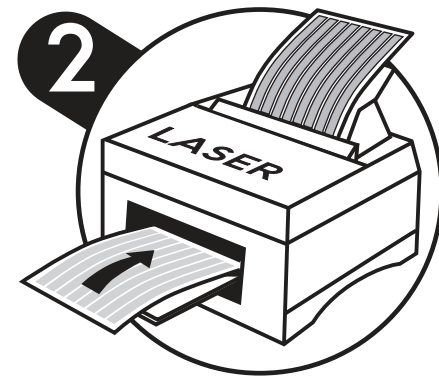
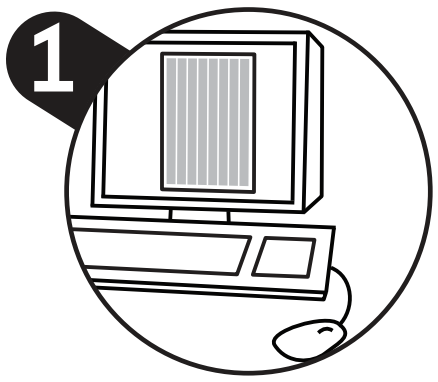

10 up Wristbands - Laser Print Template



Sheet size: A4 (21mm x 297mm)
Wristbands per sheet: 10
Wristband size: 265mm x 18mm
Gap between wristbands: 2mm
Long edge print margin: 5mm
Short edge print margin: 16mm

 Recommended print area

